

GPS L1/L2 Antenna S67-1575-256



Description

S67-1575-256: This conformal L1/L2 active GPS antenna contains a 26 dB low noise amplifier that is integrated in the antenna housing which includes band pass filtering to provide out-of-band rejection. The antenna has an internal voltage regulator and accepts +4 to +24 VDC. DC bias is provided through the center conductor of the connector. The O.M.L. of the antenna may be changed to meet your specific requirement. The antenna is furnished with a right angle SMA connector and weight nine (9) ounces.

FEDERAL & MILITARY SPECS: MIL-STD-810, MIL-C-5541, MIL-E-5400.

Specifications

Electrical

Frequency	L1: 1565 - 1585 MHz L2: 1217 - 1237 MHz
VSWR	≤ 2.0:1
Polarization	RHCP
Impedance	50 Ω
Axial Ratio	≤ 3.0 dB @ Zenith
Gain	-1.0 dBic 0° ≤ Ø ≤ 75° -2.5 dBic 75° ≤ Ø ≤ 80° -4.5 dBic 80° ≤ Ø ≤ 85° -7.5 dBic Ø = 90° @ Horizon
Gain (Preamp)	26 dB ± 3
Power Handling	1 Watt
Supply Voltage	+4 to +24 VDC @ 65 mA MAX

Mechanical

Weight	9 oz.
Height	Conformal
Width	4.50 in.
Length	6.63 in.
Material	6061-T6 Aluminum Alloy / Teflon Glass
Finish	Iridite per MIL-C-5541
Connector	Type SMA Female

Environmental

Temperature	-62°C (-80°F) to +95°C (+203°F)
Altitude	-1,500 to 70,000 ft.

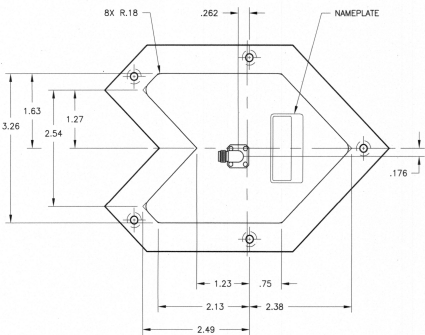
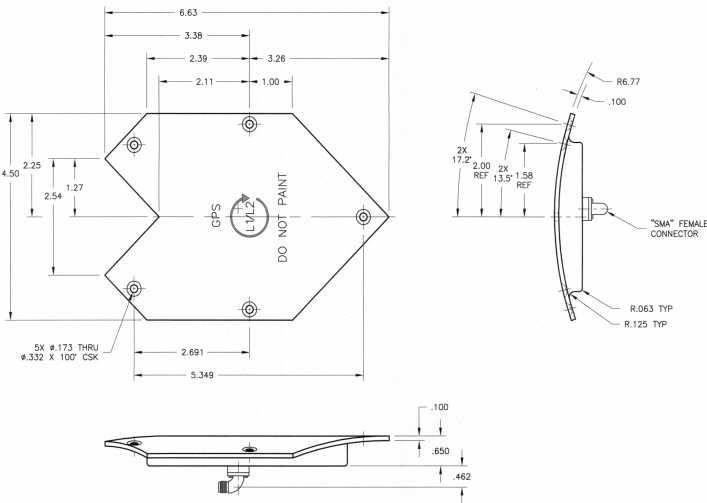

Please Note: For REFERENCE ONLY
Contact Sensor Systems for latest drawing



A HEICO COMPANY

Website: www.sensorantennas.com

Phone: 818-341-5366